

### **DC Isolator Switch Rotary Handle**

ADELS® is a professional manufacturer and supplier of DC Isolator Switch Rotary Handle in China. Dc isolator NL1 Series 1200v 32a din rail mounted solar rotary handle Rotary isolator, switch body for 4P CB4N or CB8N, the switch type is rotary switch, with two pole and four pole configuration, the product is widely used in distribution box. In the production of the handle, we choose high quality plastic material, durable material, can

maximize the service life, and the handle is ergonomic, comfortable to hold. If you have any questions about the solar rotary handle switch, please feel free to contact us, we will provide you with satisfactory service.

**Model:NL1**

ADELS® is a professional China DC Isolator Switch Rotary Handle manufacturers and suppliers, if you are looking for the best DC Isolator Switch Rotary Handle with low price, consult us now!

### **DC Isolator Switch Rotary Handle**

- IP20 Protection Level
- Din rail mounted
- Switch body for 4P CB4N or CB8N
- 2 Pole, 4 Poles are viable (Single I Double String)
- Standard: IEC60947-3, AS60947.3
- DC-PV2, DC-PV1, DC-2 IB
- 16A, 25A, 32A, 1200V DC

### **DC Isolator Switch Rotary Handle Application**

ADELS NL1 Series DC Isolator Switches are applied to 1-20 KW residential or commercial photovoltaic system, placed between photovoltage modules and inverters. Arcing time is less than 8ms, that keeps solar system more safe. To ensure its stability and long service life, our products are made by components with optimum quality. Max voltage is up to 1200V DC. It holds a safe lead among similar products.

### **Wenzhou Feimai Electric Co., Ltd.**

**Address:**No.75 Xinguang Avenue, Xinguang Industrial Zone, Liushi, Yueqing City, Zhejiang Province, P.R.China.

**Phone:**+86-13968753197

**Fax:**+86-577-62797770

**Tel:**+86-577-62797750

**E-mail:**sale@adels-solar.com

## NL1 Series DC Isolator Switches



### Electrical Characteristics

Type	FMPV16-L1/NL1/NL1-T, FMPV25-L1/NL1/NL1-T, FMPV32-L1/NL1/NL1-T
Function	Isolator;Control
Standard	IEC60947-3, AS60947. 3
Utilization category	DC-PV2/DC-PV1/DC-21B
Pole	4P
Rated frequency	DC
Rated operational voltage (Ue)	300V, 600V, 800V, 1000V, 1200V
Rated operational voltage (Ie)	See the next page
Rated insulation voltage (Ui)	1200V
Conventional free air thermal current (Ithe)	//
Conventional enclosed thermal	Same as le

#### Wenzhou Feimai Electric Co., Ltd.

**Address:**No.75 Xinguang Avenue, Xinguang Industrial Zone, Liushi, Yueqing City, Zhejiang Province, P.R.China.

**Phone:**+86-13968753197

**Fax:**+86-577-62797770

**Tel:**+86-577-62797750

**E-mail:**sale@adels-solar.com

current (I <sub>the</sub> )	
Rated short-time withstand current (I <sub>cw</sub> )	1kA, 1s
Rated impulsed withstand voltage (U <sub>imp</sub> )	8.0kV
Overvoltage category	II
Suitability for isolation	Yes
Polarity	No polarity, " + " and " - " polarities could be interchanged

## Service life/cycle operation

Mechanical	18000
Electrical	2000

## Installation Environment

Ingress protection Switch Body	IP20
Storage temperature	-40 ~ +85P
Mounting Type	Vertically or horizontally
Pollution degree	3

## Rated Voltage / Rated Current

Wiring	Type	300V	600V	800V	1000V	1200V
2P/4P	FMPV16 series	16A	16A	12A	8A	6A
	FMPV25 series	25A	25A	15A	9A	7A
	FMPV32 series	32A	27A	17A	10A	8A
4T/4B/4S	FMPV16 series	16A	16A	16A	16A	16A
	FMPV25 series	25A	25A	25A	25A	25A

### Wenzhou Feimai Electric Co., Ltd.

**Address:**No.75 Xinguang Avenue, Xinguang Industrial Zone, Liushi, Yueqing City, Zhejiang Province, P.R.China.

**Phone:**+86-13968753197

**Fax:**+86-577-62797770

**Tel:**+86-577-62797750

**E-mail:**sale@adels-solar.com

	FMPV32 series	32A	32A	32A	32A	32A
2H	FMPV16 series	35A	35A	/	/	/
	FMPV25 series	40A	40A	/	/	/
	FMPV32 series	45A	40A	/	/	/

## Switching Configurations

Type	2-pole	4-pole	2-pole4-pole in series Input and Output bottom	2-pole4-pole in series Input and Output on top	2-pole4-pole in series Input on top Output bottom	2-pole 4 paralleled Poles
/	2P	4P	4T	4B	4S	2H
Contacts Wiring graph						
Switching example						

## Dimensions(mm)

### Wenzhou Feimai Electric Co., Ltd.

**Address:**No.75 Xinguang Avenue, Xinguang Industrial Zone, Liushi, Yueqing City, Zhejiang Province, P.R.China.

**Phone:**+86-13968753197

**Fax:**+86-577-62797770

**Tel:**+86-577-62797750

**E-mail:**sale@adels-solar.com

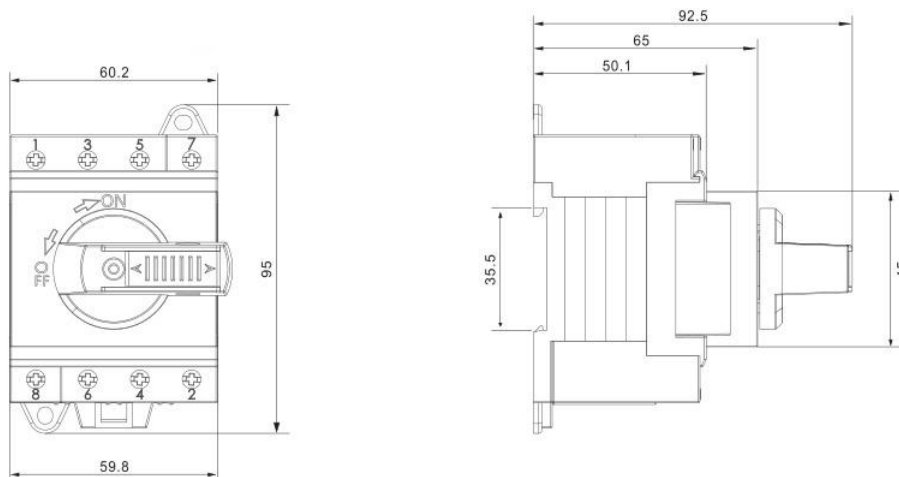

The NL1 DC Isolator Switch Rotary Handle have been specifically designed to switch Direct Current (DC) at voltages up to 1200Volts. Their robust design and ability to switch such voltages, at rated current, mean that they are ideally suited to be used in the switching of Photovoltaic (PV) systems.

The DC switch achieves ultra-rapid switching through a patented 'Snap Action' spring driven operating mechanism. When the front actuator is rotated, energy is accumulated in the patented mechanism until a point is reached at which the contacts are fired open or closed. This system will operate the switch under load within 5ms thereby reducing the arcing time to a minimum.

In order to reduce the chances of an arc propagating, the NL1 switch employs rotary contact technology. This is designed to make and break the circuit through a revolving double break contact assembly that wipes as it moves. The wiping action has the added advantage of keeping the contact faces clean thereby reducing the circuit resistance and increasing the life of the switch.

**Wenzhou Feimai Electric Co., Ltd.**

**Address:**No.75 Xinguang Avenue, Xinguang Industrial Zone, Liushi, Yueqing City, Zhejiang Province, P.R.China.

**Phone:**+86-13968753197

**Fax:**+86-577-62797770

**Tel:**+86-577-62797750

**E-mail:**sale@adels-solar.com